

STAPELEY IN GERMANTOWN



*a Quaker-sponsored
retirement community*

Our life is love, and peace, and tenderness; and bearing one with another, and forgiving one another, and not laying accusations one against another; but praying for one another, and helping one another up with a tender hand.

—*Isaac Pennington, 17th-Century Quaker*

Welcome to Stapeley



*a Quaker-sponsored
retirement community*

Stapeley in Germantown is a retirement community operated by a Board of Managers appointed by the Philadelphia Quarterly Meeting of the Religious Society of Friends (the Quaker Meetings of the city of Philadelphia). It welcomes residents and staff of all faiths, races, and cultural backgrounds. It has three dimensions: apartments for independent living; a nursing home with skilled and intermediate care; and a licensed personal care residence where assisted living is available. The personal care residence has been in continuous operation since 1904; the other sections opened in 1985.

The vision and generosity of founder Anna T. Jeanes enables Stapeley to offer services for the physical, emotional, recreational, social, and religious needs of those in retirement today. Continuity of care for moderate income people is provided in a setting unique among Quaker retirement communities: a homelike atmosphere of simplicity within a stimulating urban setting. Fees are kept as low as is consistent with standards of quality of service and respectable compensation for staff.

Care for Every Person

Principles central to Quaker religious perspective are reflected in life at Stapeley. The belief that there is that of God in every person leads to concern for community, harmony, equality, simplicity, and integrity. These values are reflected when the Board of Managers addresses policy responsibilities, when

staff attend to the needs of residents, and when residents relate to the staff and to one another.

A spirit of mutual respect among board, staff and residents enables Stapeley to provide care in a setting for life. This includes secure shelter, an orderly environment, and services tendered in a manner which maintains the recipient's dignity, self confidence, and appropriate degree of independence. The labor of all members of the Stapeley community is recognized and valued so that each may share in its dynamic, developing life.

Communication and Decision-Making

All who participate in the life of Stapeley In Germantown have the equal obligation to communicate their views and to remain open to hearing the views and concerns of others. While responsibility for different decisions necessarily lies with different segments of the community full communication and consultation is expected on all major decisions. Stapeley has grown and changed over the years, yet remains dedicated to caring.

*Adopted by the Board of Managers
May 24, 1988*



Helping One Another



in the Quaker tradition

Stapeley was founded in 1904 as the Boarding Home for the Philadelphia Quarterly Meeting of Friends. The original building on its five-acre site was a gift from Anna T. Jeanes. Anna Jeanes personally supervised construction and spent the last three years of her life at Stapeley, helping to meet the needs of other residents.

In 1985 Stapeley expanded, providing modern apartments for independent living in Stapeley West, personal care units in the tastefully refurbished original boarding home space, and intermediate and skilled nursing care in a new health care center. This carefully designed expansion resulted in a self-contained community which permits access to all living areas, the dining room, and a wide variety of services under one roof.

In 1996 Stapeley undertook major renovations to the original 1904 building. Included among the many changes were: the installation of a new central heating/air conditioning system; a complete sprinkler system; the addition of full private bathrooms to every personal care room; the addition of a sunny satellite dining room; and new carpeting, lighting fixtures, and replacement windows throughout the

building. The ground floor was transformed into a mini-mall (residents have dubbed it “the Mall in the Hall”). It has a new beauty/barber shop, a fitness center, a small grocery center (“Stapeley Staples”) and a large recreation room. During this busy time Stapeley also applied for and received full certification from the Continuing Care Accreditation Commission.

The Stapeley tradition manifests itself in a spirit of mutual respect among board, staff, and residents. This spirit enables Stapeley to provide secure shelter in an orderly environment. Services are offered with affection, in a manner that maintains the resident’s dignity and self-confidence and encourages as much independence as possible. Stapeley’s goal is for each resident to achieve a dynamic, developing life in an environment where all faiths, races, and cultural backgrounds are welcomed and cherished.



In Germantown...



Germantown House, built circa 1890

*a vibrant community where
the past meets the future*

Stapeley is located in Germantown, a Northwest Philadelphia neighborhood with 300 years of history, a diverse population, and a rich variety of shops, churches and Quaker meetings, historic treasures, parks, and other resources. Founded by German settlers in the 17th century, Germantown was for many years an independent community. It became part of Philadelphia in 1854, but has retained its small-town feeling throughout its history.

Germantown's historic houses—including Upsala, the Deshler-Morris House, Cliveden, the Johnson House, and the Germantown Mennonite Meeting House, which is still in use—provide education for students and tourists. Upsala and Cliveden were important locations during the Battle of Germantown (1777). The Johnson House, one of the stations on the Underground Railroad, helped rescue thousands from slavery before the Civil War. Germantown's less famous houses provide many fine examples of Victorian architecture. Many of them are surrounded by well-maintained Victorian gardens.

Yet the life of Germantown is less about the past than about the fu-

ture. Germantown is host to many fine schools, including Germantown Friends School, Settlement Music School, William Penn Charter School, and the Pennsylvania School for the Deaf. Germantown's citizens are involved in their community through block organizations and area-wide efforts like the Central Germantown Council and the Germantown Settlement.

Stapeley is committed to the future of Germantown. In an era when many institutions are leaving urban areas, Stapeley has chosen to stay and build. More than half of its residents come from within a five-mile radius. They have chosen Stapeley because it provides quality, affordable care in a vibrant community.

Germantown is a neighborhood where past and future meet to create a unique way of life. Stapeley is proud to be part of that tradition.



Meeting Your Needs

Stapeley offers three levels of care

In 1985 Stapeley expanded to include modern apartments for an independent lifestyle and skilled nursing care in a modern health care center. The original boarding home has been refurbished and now has seventy assisted living units with modern bathrooms.

Stapeley West—Independent Living

For residents who can live independently, Stapeley West's 43 apartments provide a pleasant, enriching lifestyle—and the security of knowing that, if needed, additional care is available.

Stapeley Hall—Assisted Living

Stapeley Hall's 79 assisted living units are ideal for residents who need help with some of the routine tasks of living, but still wish to retain their independence. The recent addition of a satellite dining room provides a pleasant alternative for residents who cannot walk the extra distance to the central dining area.

Health Care Center—Skilled Nursing

For those who need more extensive support, the Health Care Center, located on the first and second floor of Stapeley West, provides a fully-equipped skilled nursing facility with 120 beds—116 in private rooms and 4 in semi-private.



Our certification is your assurance of quality

In 1996, Stapeley was certified by the Continuing Care Accreditation Commission (CCAC). CCAC awards accreditation when a Continuing Care Retirement Community has been found to be effectively carrying out its own mission and purposes and to be meeting or exceeding CCAC's published standards.

CCAC accreditation is a seal of approval which tells you that Stapeley

- ✓ meets national standards of excellence in every aspect of its operation;
- ✓ has a clearly-defined mission which guides all of its work and the work of its staff; and

- ✓ participates in an ongoing process of self-evaluation in order to maintain its quality record.

Accreditation provides assurance of quality and integrity and demonstrates Stapeley's genuine interest in continuous self-evaluation and self-improvement. It offers the public a standard for comparison in evaluating retirement communities.



Comfort and Security



*in attractive, well-equipped
facilities*

Stapeley offers a comfortable, secure environment where new residents quickly feel at home and long-time residents can find new delights every day. Its facilities offer historic ambiance and modern convenience, quiet places for meditation and busy places for an active lifestyle. The whole facility is designed to provide ease of access and use for everyone. All parts of Stapeley are connected so that residents can move from apartment to dining room to common room with ease and comfort. A skilled nursing facility provides complete medical care. When you choose Stapeley, you can be sure that you have chosen a fully-equipped, well-designed place to live.

Stapeley Hall

Directly facing Greene Street is historic Stapeley Hall, the original building of the Stapeley complex. Once a simple boarding home for elderly Quakers, Stapeley Hall now is an updated facility that has maintained its historic and welcoming ambiance. Each of its 70 assisted living units is unique and ready for its resident to decorate and make into his or her home. Stapeley Hall also offers an exercise room, a beauty parlor, an activities room, a common room, and other gathering places which are vital to the life of this special community.

The Bridge

Connecting Stapeley Hall with the newer Stapeley West is The Bridge, a glassed-in walkway that overlooks the grounds. Although best known for its spectacular views, The Bridge is also

a popular place for residents to gather and sit throughout the day. It is home to a regularly-changing art exhibit featuring works of both resident and non-resident artists.

Stapeley West

Completed in 1985, Stapeley West is a comfortable, modern facility which is home to 43 apartments for independent living and a 120-bed skilled nursing facility. An independent apartment in Stapeley West includes a full kitchen with refrigerator, resident-controlled heating and cooling, and a balcony with a view of the grounds. Wall-to-wall carpeting adds to the apartment's comfort; curtains on the balcony windows assure privacy.

The Health Care Center, which is located on the first and second floors of Stapeley West, is a complete nursing facility for those who can no longer manage for themselves. The staff here are specially trained to meet the needs of each resident and to promote independence. All staff take special care to treat residents with the respect that is central to the Quaker heritage.

Security

At Stapeley, care is taken to assure each resident's privacy and security. Visitors to Stapeley must sign in at the front desk and must display visitors' badges. Each independent living apartment has its own locking door, as do the rooms in Stapeley Hall. Stapeley West's entrance is staffed 24 hours a day.



Abundant Life Ea



ch Day at Stapeley

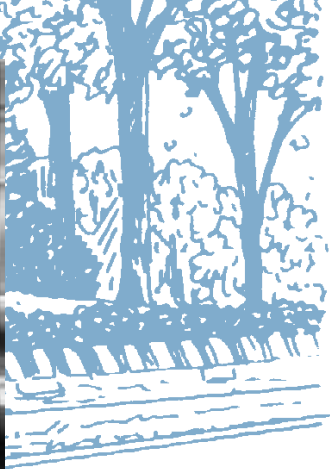

Handwritten signature or initials.



A Range of Services



*choices and options
for all residents*

Stapeley encourages all residents to participate in a full, active lifestyle. It welcomes people of all faiths, races, and cultural backgrounds. Activities, amenities, and special features enable Stapeley to provide a stimulating milieu with a wide range of interesting things to do. From discussion groups to scrabble—we have it all! Our van provides transport to the many cultural attractions in and around Philadelphia. An afternoon concert at the Academy of Music, a picnic at Valley Green, or a fall foliage tour are just a few of the trips offered during the year.

In addition to our well-stocked Gift Shop, Stapeley Staples, and the regular visits from clothing and shoe stores, we feature monthly shopping trips to Plymouth Meeting Mall. Our beautiful grounds provide areas for individual garden plots, and the newly installed raised flower beds will open gardening activities to more residents. Our recent renovations include a modern beauty/barber shop and a well-equipped fitness center. Stapeley offers enough options and choices to accommodate the interests and satisfy the needs of the entire Stapeley family.

Special Features

- Five acres of grounds with space for individual planting
- Glass enclosed bridge which provides a bird's eye view of the changing seasons
- Plant rooms
- Gift shop and grocery store
- Beauty and barber shop
- Large parlor for visitors and for special events
- Guest room for overnight visitors
- Attractive porches
- Recreation room with large screen television and kitchen facilities
- Scenic walking paths
- Cheerful, bright dining rooms

Stapeley West—Independent Living

- One meal daily included in monthly fee
- Monthly housekeeping
- Full maintenance service
- On-site parking
- Emergency call system
- Sprinkler system throughout
- Cultural and social activities
- Priority admission to Health Care Center
- Van transportation
- Laundry facilities on each floor
- 24-hour security staff
- Cable hookup in apartments
- Curtains and wall-to-wall carpeting
- All utilities included in monthly fee
- Individually controlled heating and cooling
- Locker space for storage
- Full time Social Worker

Stapeley Hall—Assisted Living

- Three meals daily included in monthly fee
- Choice of main or satellite dining room
- Bi-weekly housekeeping
- Full maintenance service and 24-hour security
- Emergency call system and sprinkler system
- Cultural and social activities
- Priority admission to Health Care Center
- Van transportation
- Weekly laundry service (linens and towels supplied)
- Mini blinds and wall-to-wall carpeting
- All utilities included in monthly fee
- Individually controlled heating and cooling
- Assistance as needed with bathing, grooming, and medications
- 24-hour nursing staff
- Full time Social Worker

Health Care Center—Skilled Nursing

- Medical care supervised by a certified Gerontologist
- 24-hour nursing care
- Laundry and linen service
- Activities program
- Full time social worker
- All meals and snacks
- Off-street visitor parking
- Daily mail delivery
- Phone jacks in each room
- Regularly scheduled resident care meetings
- Physical, occupational, and speech therapy
- Restorative nursing program



Healthy Surroundings



*our grounds provide beauty
and inspiration*

Stapeley is located on five acres of land at the intersection of Washington Lane and Greene Streets in Germantown.

Stapeley Hall, the original boarding home, faces Greene Street. The Stapeley grounds extend west from the Hall for approximately 500 feet to Moylan Street. Within them, visitors and residents will find a natural environment with beauty for the eye, fresh air for the lungs, and inspiration for the spirit.

Immediately behind Stapeley Hall, a wooded hillside traversed by winding paths provides spectacular views and opportunities for healthful exercise for residents who enjoy walking. For those who can no longer manage the climb, there is an overlook at the top with a view of the entire grounds. The hillside is home to a miniature hardwood forest, including hickory, dogwood, tulip poplar, American beech, and black oak. A fascinating variety of birds and wildlife make their homes here.

The hillside descends to an attrac-

tive space, with shady spots for sitting, level paths for moderate exercise and wheelchair rides, and plots for resident-maintained gardens.

Residents and visitors may also view the grounds from the glass walkway (the Bridge) that connects Stapeley Hall with Stapeley West. A favorite space for Stapeley's residents, the walkway provides sheltered viewing in bad weather and sunny vistas on clear days.

Stapeley's grounds are one of the beauty spots of Germantown, lovingly preserved by all in the Stapeley community. Our residents, our staff, even those who only visit us briefly, never forget their calm, their play of light and shade, and their abundant life.



Building for the Future



while preserving the past

Stapeley is building for the future on a strong foundation.

Since 1904, Stapeley has welcomed change, yet remained rooted in Quaker traditions. In 1985, it expanded to include Stapeley West, a modern facility for independent living. The Health Care Center, attached to Stapeley West, provides skilled nursing so that residents who need this type of care can remain in the surroundings that are their home.

Renovations in Stapeley Hall, the original facility, have made it one of the most attractive assisted living facilities in Philadelphia. Our reconstruction preserves the historic character of the building; provides a comfortable and convenient way of life to residents; and makes common areas attractive and accessible for all.

But building for the future means more than bricks and mortar. In the past, Stapeley's pioneering efforts have helped to change the nature of care for the elderly. Today, as the health care system changes, Stapeley is constantly looking for ways to provide the best services at the lowest cost to residents. Its list of activities for residents is growing. And, through resident committees and representatives on the Stapeley Board of Managers, residents have a voice in changes affecting them.

This is Stapeley's commitment and belief: that working together, we can build a strong future that preserves the best of our past.



Spacious Apartments

Forty-two modern apartments are located on the four top floors of Stapeley West, connected to the original building by a glass-enclosed bridge overlooking our wooded hillside. Individual balconies provide a private area where residents can enjoy the beautiful Stapeley gardens.

Studio Apartment

Stapeley's studio apartment offers convenient living at an affordable price. It is well-suited for a single resident who seeks comfort, efficiency, and independence.

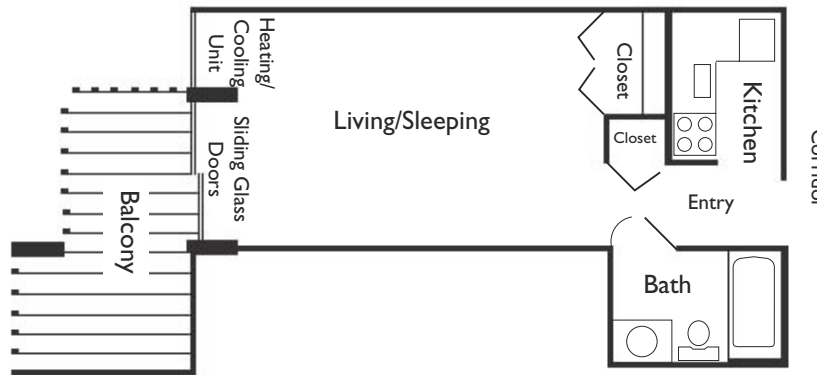

Living Space
11' 5" x 20' 8"

- Wall-to-wall carpeting
- Sheer curtains
- Private balcony

Studio Apartment with Alcove

Stapeley's studio apartment with sleeping alcove offers convenient living and additional space at an affordable price. It is ideal for residents who seek comfort, efficiency, and independence but need more living space than the studio apartment affords.

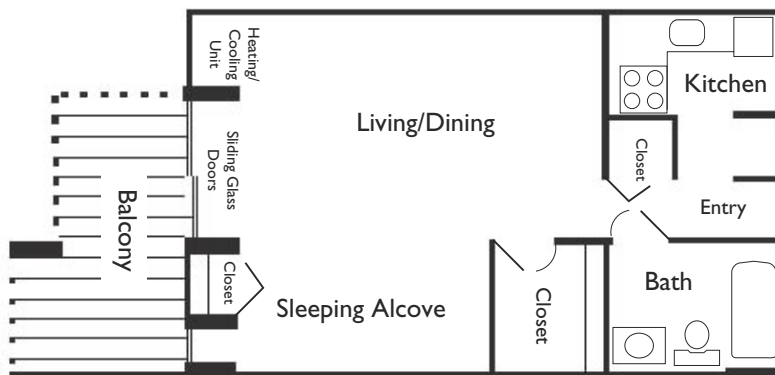

Living Space
11' 5" x 20' 8"

Sleeping Alcove
5' 9" x 12' 0"

- Wall-to-wall carpeting
- Sheer curtains
- Private balcony

All apartments include:

- Curtains and wall-to-wall carpeting
- Monthly cleaning
- All utilities
- One meal daily
- Individually-controlled heating and cooling
- Emergency call system
- Fully-equipped kitchen

- Cultural and social activities
- On-site parking
- 24-hour maintenance, security, and receptionist
- Locker space for storage
- Sprinkler system throughout
- Cable-ready

for an independent lifestyle

One-Bedroom Apartment

For those who need additional space, Stapeley's one-bedroom apartment offers the ideal combination of comfortable design and affordable price.

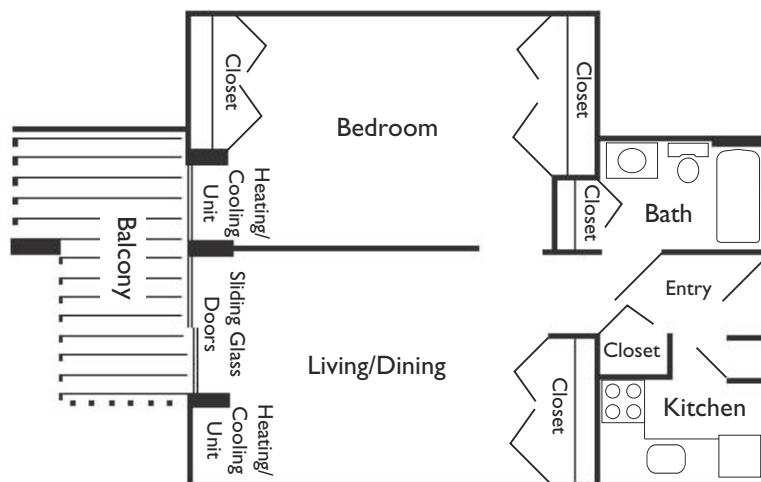

Corridor
Living Space
11' 6" x 18' 6"
Bedroom
11' 9" x 16' 5"

- Wall-to-wall carpeting
- Sheer curtains
- Private balcony

Two-Bedroom Apartment with Study

Stapeley's two-bedroom apartment offers the ultimate in privacy and independent living for those who need or want more living space than the other apartments we offer.

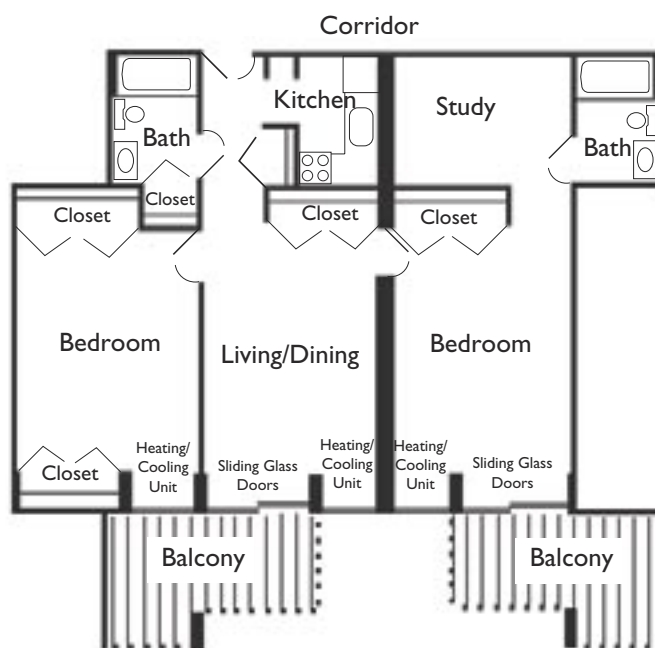

Living Space
11' 6" x 18' 8"
Bedroom 1
11' 7" x 18' 8"
Bedroom 2
11' 10" x 16' 5"
Study
8' 5" x 11' 5"

- Wall-to-wall carpeting
- Sheer curtains
- Private balcony

Come and Join Us

Stapeley's admission procedure



At Stapeley, we want to be sure that each new resident will enjoy a good life at our facility, and that he or she chooses the level of care and lifestyle that is appropriate to his or her situation. Our admission procedure includes the following steps:

- ✓ On-site tour with Admissions Director
- ✓ Completion of application forms with Priority List fee (Stapeley West - \$1,000 Stapeley Hall - \$500)
- ✓ Review of application and financial information to determine initial eligibility
- ✓ Pre-admission physical examination with Stapeley's Medical Director
- ✓ Three night pre-admission evaluation in Stapeley's Guest Room (for Stapeley Hall admissions only)
- ✓ Notification of availability and admission date
- ✓ Signing of Residence and Care agreement and payment of entry fee

How to reach Stapeley

Stapeley is conveniently located for both residents and visitors. Public transportation to central Philadelphia and the Northwest section of the city is within walking distance. By car, Stapeley is easy to reach from the Schuylkill Expressway and Lincoln Drive.

Connections to the Northwest

SEPTA's Route H bus, which services Germantown, Mt. Airy, and Cheltenham, stops outside Stapeley's front door. The H bus also connects with SEPTA's Route 23 bus for those who wish to shop in Chestnut Hill.

An even more convenient route to Chestnut Hill via the R8 Chestnut Hill local train is available at the Upsal station, within easy walking distance of Stapeley.

Connections to and from Center City

From Center City Philadelphia, one can reach Stapeley via the R8 Chestnut Hill local, which departs once per hour from Market East, Suburban, and 30th Street Stations. Get off at the Upsal Station and follow the map at right.

By Car from the Schuylkill Expressway (I-76)

From the Schuylkill Expressway, take the Lincoln Drive exit. Follow Lincoln Drive to Johnson Street and turn right. At Greene Street, turn right again. Stapeley will be on your right about two blocks from Johnson Street.

Whatever route you choose, Stapeley provides ample parking for visitors.

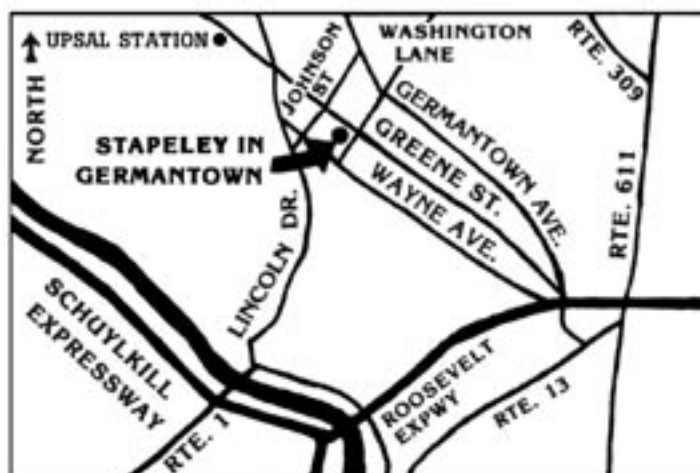

Notes